

## Plot 177



## PLOT 177 (0)

**Kitchen**  
16'7" x 6'1" (5065 x 1850mm)

**Living/Dining**  
29'3" x 17'7" (8920 x 5360mm)

**Bedroom 1**  
19'9" x 11'4" (6020 x 3465mm)

**En suite**  
6'10" x 5'0" (2085 x 1535mm)

**Bedroom 2**  
16'0" x 10'1" (4870 x 3075mm)

**Bedroom 3**  
16'0" x 10'6" (4870 x 3210mm)

**Bathroom**  
6'10" x 6'6" (2085 x 1985mm)

**TOTAL AREA**  
1200 sq ft (111.5 sq m)

**Terrace 1**  
22'0" x 5'4" (6710 x 1620mm)

**Terrace 2**  
25'2" x 12'8" (7660 x 3870mm)

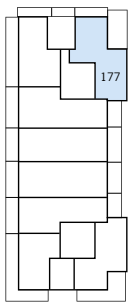

Ground Floor

## Plot 178

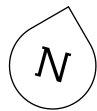

## PLOT 178 (0)

**Kitchen**  
12'5" x 5'11" (3775 x 1800mm)

**Living/Dining**  
26'4" x 12'7" (8020 x 3835mm)

**Bedroom 1**  
24'0" x 9'0" (7325 x 2750mm)

**En suite**  
6'10" x 5'0" (2085 x 1535mm)

**Bedroom 2**  
18'1" x 9'0" (5500 x 2750mm)

**Bedroom 3**  
19'9" x 9'10" (6015 x 3000mm)

**Bathroom**  
6'10" x 6'6" (2085 x 1985mm)

**TOTAL AREA**  
1267 sq ft (117.7 sq m)

**Terrace 1**  
27'3" x 7'8" (8300 x 2330mm)

**Terrace 2**  
17'0" x 8'10" (5180 x 2700mm)

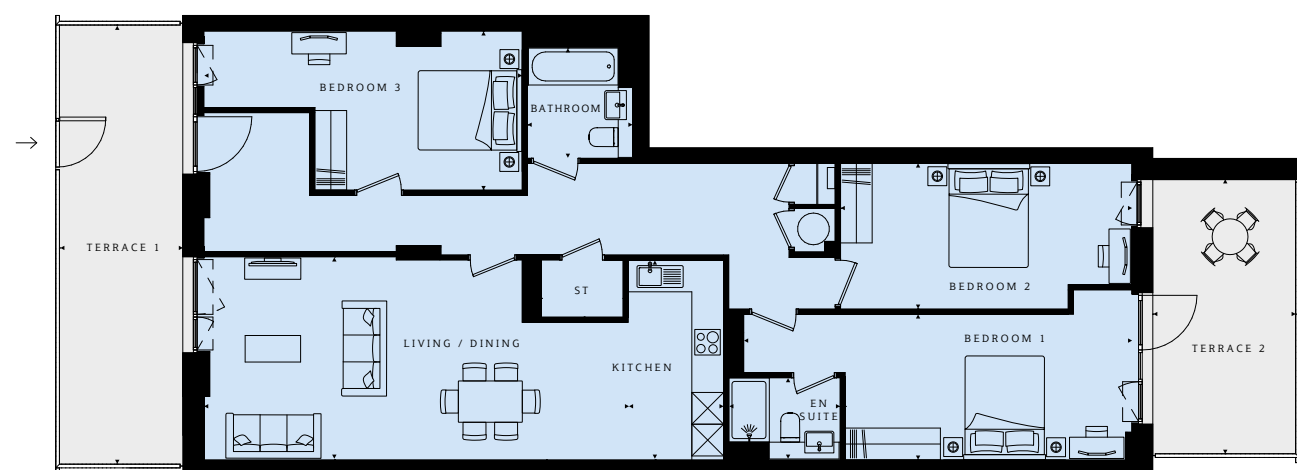
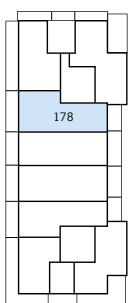

Ground Floor

Plot 179



PLOT 179 (0)

**Kitchen**  
9'11" x 8'0" (3020 x 2450mm)

**Living/Dining**  
21'10" x 11'10" (6660 x 3600mm)

**Bedroom 1**  
24'6" x 9'3" (7480 x 2825mm)

**En suite**  
6'10" x 5'0" (2085 x 1535mm)

**Bedroom 2**  
18'0" x 9'3" (5475 x 2825mm)

**Bedroom 3**  
18'6" x 8'0" (5650 x 2450mm)

**Bathroom**  
6'10" x 6'6" (2085 x 1985mm)

**TOTAL AREA**  
1225 sq ft (113.8 sq m)

**Terrace 1**  
22'0" x 7'8" (6700 x 2330mm)

**Terrace 2**  
22'9" x 8'10" (6925 x 2700mm)

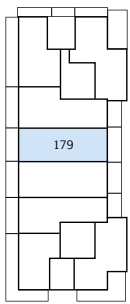
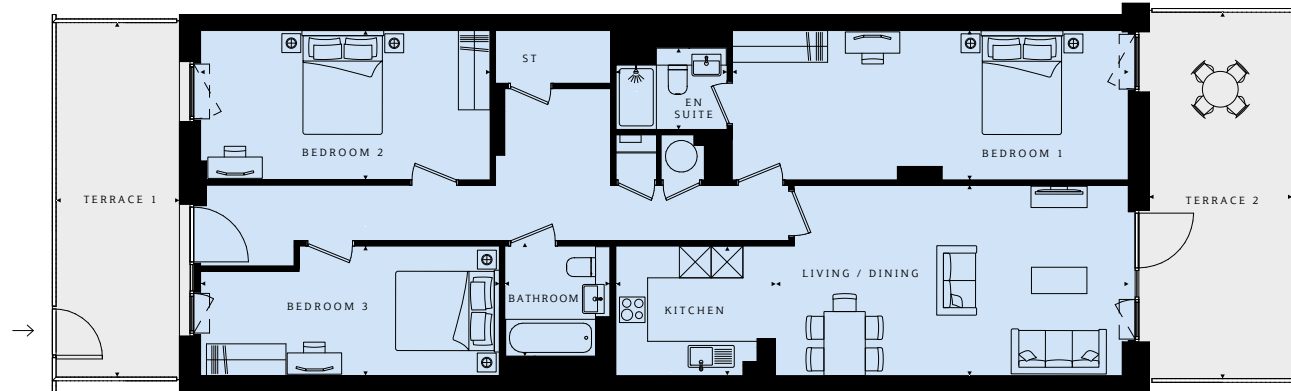

Ground Floor

Plot 184

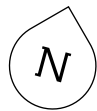

PLOT 184 (1)

**Kitchen**  
16'7" x 6'1" (5065 x 1850mm)

**Living/Dining**  
29'3" x 17'7" (8920 x 5360mm)

**Bedroom 1**  
19'9" x 11'5" (6020 x 3485mm)

**En suite**  
6'10" x 5'0" (2085 x 1535mm)

**Bedroom 2**  
16'1" x 10'6" (4890 x 3210mm)

**Bedroom 3**  
16'1" x 10'2" (4890 x 3095mm)

**Bathroom**  
6'10" x 6'6" (2085 x 1985mm)

**TOTAL AREA**  
1200 sq ft (111.4 sq m)

**Balcony 1**  
20'8" x 4'7" (6290 x 1405mm)

**Balcony 2**  
12'0" x 5'9" (3655 x 1745mm)

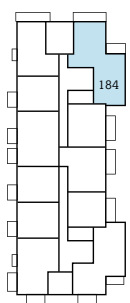

Level 1

Plot 185

**PLOT 185 (1)**

**Kitchen**  
13'9" x 5'9" (4195 x 1755mm)

**Living/Dining**  
18'3" x 16'7" (5560 x 5050mm)

**Bedroom**  
12'9" x 10'11" (3880 x 3330mm)

**Bathroom**  
6'10" x 6'6" (2085 x 1985mm)

**TOTAL AREA**  
665 sq ft (61.8 sq m)

**Balcony**  
15'2" x 5'4" (4625 x 1635mm)

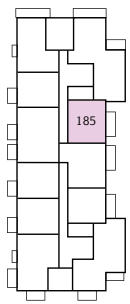

Level 1

Plot 259

**PLOT 259 (7)**

**Kitchen**  
14'5" x 6'7" (4400 x 2000mm)

**Living/Dining**  
20'1" x 14'5" (6115 x 4400mm)

**Bedroom 1**  
10'3" x 10'3" (3120 x 3115mm)

**En suite**  
6'10" x 5'0" (2085 x 1535mm)

**Bedroom 2**  
19'9" x 10'6" (6015 x 3190mm)

**Bathroom**  
6'10" x 6'6" (2085 x 1985mm)

**TOTAL AREA**  
948 sq ft (88.0 sq m)

**Balcony 1**  
8'11" x 5'4" (2710 x 1635mm)

**Balcony 2**  
8'11" x 5'4" (2710 x 1635mm)

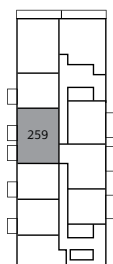

Level 7

Upton Gardens - Chapman House  
Block G

Plots 192, 204, 216, 228, 240 and 250



**PLOTS 192 (1), 204 (2), 216 (3), 228 (4), 240 (5), 250 (6)**

**Kitchen**  
14'6" x 6'7" (4420 x 2000mm)

**Living/Dining**  
20'1" x 14'6" (6115 x 4420mm)

**Bedroom 1**  
10'5" x 10'3" (3175 x 3135mm)

**En suite**  
6'10" x 5'0" (2085 x 1535mm)

**Bedroom 2**  
19'10" x 10'6" (6035 x 3200mm)

**Bathroom**  
6'10" x 6'6" (2085 x 1985mm)

**TOTAL AREA**  
948 sq ft (88.0 sq m)

**Balcony 1**  
8'11" x 5'4" (2710 x 1635mm)

**Balcony 2**  
8'11" x 5'4" (2710 x 1635mm)

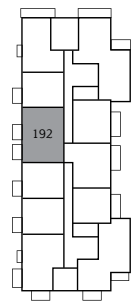

Level 1

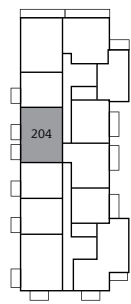

Level 2

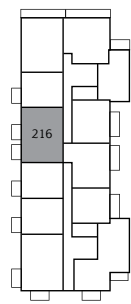

Level 3

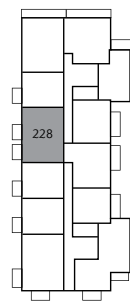

Level 4

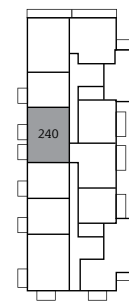

Level 5

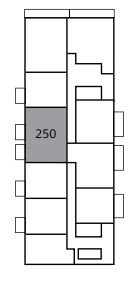

Level 6

Plot 260



**PLOT 260 (7)**

**Kitchen**  
9'0" x 6'1" (2745 x 1850mm)

**Living/Dining**  
20'7" x 11'10" (6265 x 3600mm)

**Bedroom**  
13'8" x 10'6" (4160 x 3200mm)

**Bathroom**  
6'10" x 6'6" (2085 x 1985mm)

**TOTAL AREA**  
600 sq ft (55.7 sq m)

**Balcony**  
8'11" x 5'4" (2710 x 1635mm)

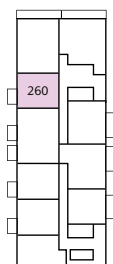

Level 7

Plots 193, 217, 229, 241 and 251



**PLOTS 193 (1), 217 (3), 229 (4), 241 (5), 251 (6)**

**Kitchen**  
9'1" x 6'1" (2765 x 1850mm)

**Living/Dining**  
20'7" x 11'11" (6265 x 3620mm)

**Bedroom**  
13'9" x 10'6" (4180 x 3200mm)

**Bathroom**  
6'10" x 6'6" (2085 x 1985mm)

**TOTAL AREA**  
600 sq ft (55.7 sq m)

**Balcony**  
8'11" x 5'4" (2710 x 1635mm)

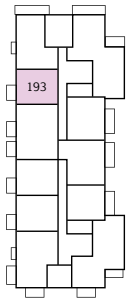

Level 1

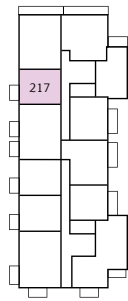

Level 3

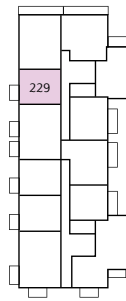

Level 4

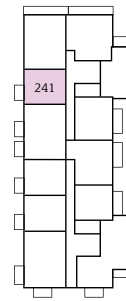

Level 5

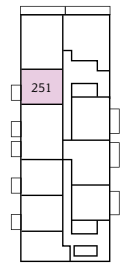

Level 6

Plot 194



**PLOT 194 (1)**

**Kitchen**  
15'8" x 5'11" (4770 x 1800mm)

**Living/Dining**  
15'8" x 11'5" (4770 x 3485mm)

**Bedroom 1**  
16'2" x 9'7" (4915 x 2930mm)

**En suite**  
6'10" x 5'0" (2085 x 1535mm)

**Bedroom 2**  
11'2" x 9'1" (3415 x 2760mm)

**Bathroom**  
6'10" x 6'6" (2085 x 1985mm)

**TOTAL AREA**  
736 sq ft (68.4 sq m)

**Balcony**  
20'8" x 4'7" (6290 x 1405mm)

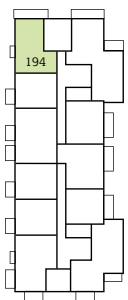

Level 1

Plots 195, 207, 219 and 231



**PLOTS 195 (2), 207 (3), 219 (4), 231 (5)**

**Kitchen**  
9'5" x 6'10" (2870 x 2080mm)

**Living/Dining**  
22'5" x 11'2" (6840 x 3410mm)

**Bedroom 1**  
18'8" x 8'10" (5685 x 2690mm)

**En suite**  
6'10" x 5'0" (2085 x 1535mm)

**Bedroom 2**  
18'8" x 9'4" (5685 x 2855mm)

**Bathroom**  
6'10" x 6'6" (2085 x 1985mm)

**TOTAL AREA**  
826 sq ft (76.7 sq m)

**Balcony**  
29'1" x 4'7" (8875 x 1405mm)

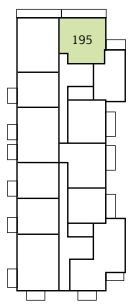

Level 2

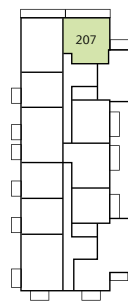

Level 3

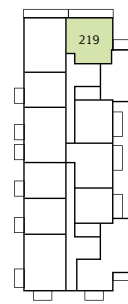

Level 4

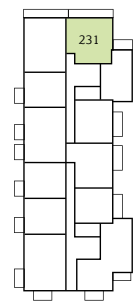

Level 5

Plots 196, 208, 220 and 232



**PLOTS 196 (2), 208 (3), 220 (4), 232 (5)**

**Kitchen**  
12'5" x 5'11" (3775 x 1800mm)

**Living/Dining**  
15'1" x 12'5" (4585 x 3775mm)

**Bedroom**  
12'7" x 11'5" (3840 x 3485mm)

**Bathroom**  
6'10" x 6'6" (2085 x 1985mm)

**TOTAL AREA**  
571 sq ft (53.1 sq m)

**Balcony**  
12'0" x 5'9" (3655 x 1745mm)

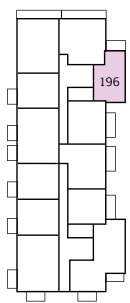

Level 2

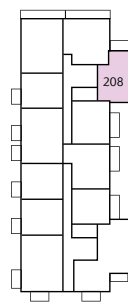

Level 3

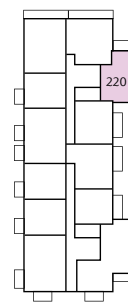

Level 4

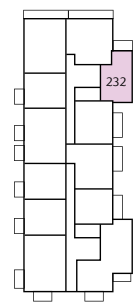

Level 5

Plots 206, 218, 230, 242 and 252

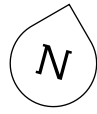

**PLOTS 206 (2), 218 (3), 230 (4), 242 (5), 252 (6)**

**Kitchen**  
15'9" x 4'11" (4800 x 1500mm)

**Living/Dining**  
21'3" x 12'5" (6485 x 3785mm)

**Bedroom 1**  
16'2" x 9'7" (4915 x 2930mm)

**En suite**  
6'10" x 5'0" (2085 x 1535mm)

**Bedroom 2**  
15'6" x 9'0" (4730 x 2750mm)

**Bedroom 3**  
10'10" x 9'1" (3300 x 2760mm)

**Bathroom**  
6'10" x 6'6" (2085 x 1985mm)

**TOTAL AREA**  
923 sq ft (85.8 sq m)

**Balcony**  
29'1" x 4'7" (8875 x 1405mm)

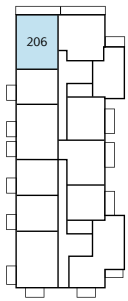

Level 2

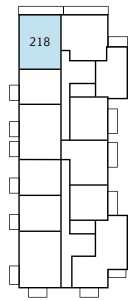

Level 3

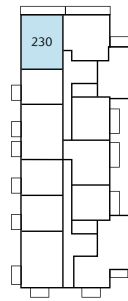

Level 4

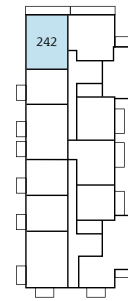

Level 5

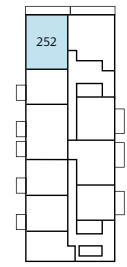

Level 6

Plot 253



**PLOT 253 (7)**

**Kitchen**  
14'11" x 5'11" (4535 x 1800mm)

**Living/Dining**  
18'8" x 15'1" (5690 x 4585mm)

**Bedroom 1**  
16'9" x 11'5" (5115 x 3490mm)

**En suite**  
6'10" x 5'0" (2085 x 1535mm)

**Bedroom 2**  
14'11" x 12'5" (4535 x 3780mm)

**Bathroom**  
6'10" x 6'6" (2085 x 1985mm)

**TOTAL AREA**  
877 sq ft (81.5 sq m)

**Balcony**  
29'1" x 4'7" (8875 x 1405mm)

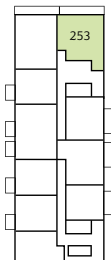

Level 7

## Plot 243



## PLOT 243 (6)

**Kitchen**  
14'11" x 5'11" (4555 x 1800mm)

**Living/Dining**  
18'8" x 15'1" (5700 x 4585mm)

**Bedroom 1**  
16'10" x 11'7" (5135 x 3520mm)

**En suite**  
6'10" x 5'0" (2085 x 1535mm)

**Bedroom 2**  
14'11" x 12'6" (4555 x 3800mm)

**Bathroom**  
6'10" x 6'6" (2085 x 1985mm)

**TOTAL AREA**  
877 sq ft (81.5 sq m)

**Balcony**  
29'1" x 4'7" (8875 x 1405mm)

**Terrace**  
21'8" x 11'7" (6615 x 3540mm)

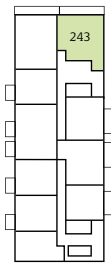

Level 6

## Plot 254



## PLOT 254 (7)

**Kitchen**  
8'6" x 8'5" (2600 x 2560mm)

**Living/Dining**  
16'2" x 15'6" (4925 x 4715mm)

**Bedroom**  
14'8" x 11'3" (4465 x 3435mm)

**Bathroom**  
9'0" x 8'1" (2735 x 2465mm)

**TOTAL AREA**  
665 sq ft (61.8 sq m)

**Balcony**  
15'2" x 5'4" (4625 x 1635mm)

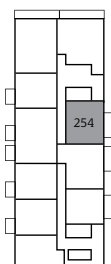

Level 7



Plots 261

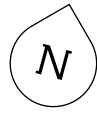

**PLOT 261 (7)**

**Kitchen**  
15'9" x 4'11" (4800 x 1500mm)

**Living/Dining**  
21'3" x 12'4" (6485 x 3765mm)

**Bedroom 1**  
12'6" x 9'6" (3815 x 2890mm)

**En suite**  
6'10" x 5'0" (2085 x 1535mm)

**Bedroom 2**  
15'5" x 9'0" (4710 x 2750mm)

**Bedroom 3**  
10'9" x 9'1" (3280 x 2780mm)

**Bathroom**  
6'10" x 6'6" (2085 x 1985mm)

**TOTAL AREA**  
923 sq ft (85.8 sq m)

**Balcony**  
29'1" x 4'7" (8875 x 1405mm)

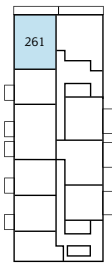

Level 7

Plots 197, 209, 221, 233 and 244



**PLOTS 197 (2), 209 (3), 221 (4), 233 (5), 244 (6)**

**Kitchen**  
8'6" x 8'6" (2600 x 2580mm)

**Living/Dining**  
16'2" x 15'6" (4925 x 4715mm)

**Bedroom**  
14'9" x 11'4" (4485 x 3455mm)

**Bathroom**  
9'0" x 8'1" (2735 x 2465mm)

**TOTAL AREA**  
665 sq ft (61.8 sq m)

**Balcony**  
15'2" x 5'4" (4625 x 1635mm)

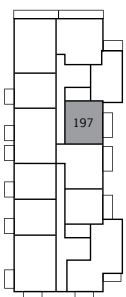

Level 2

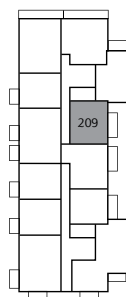

Level 3

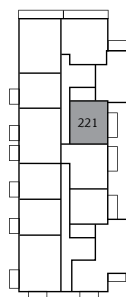

Level 4

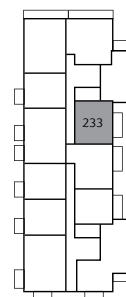

Level 5

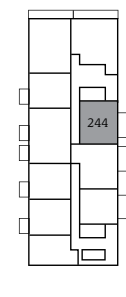

Level 6